

SOMERVILLE
MIDDLESEX COUNTY
MASSACHUSETTS

70 INNER BELT ROAD
SOMERVILLE, MA

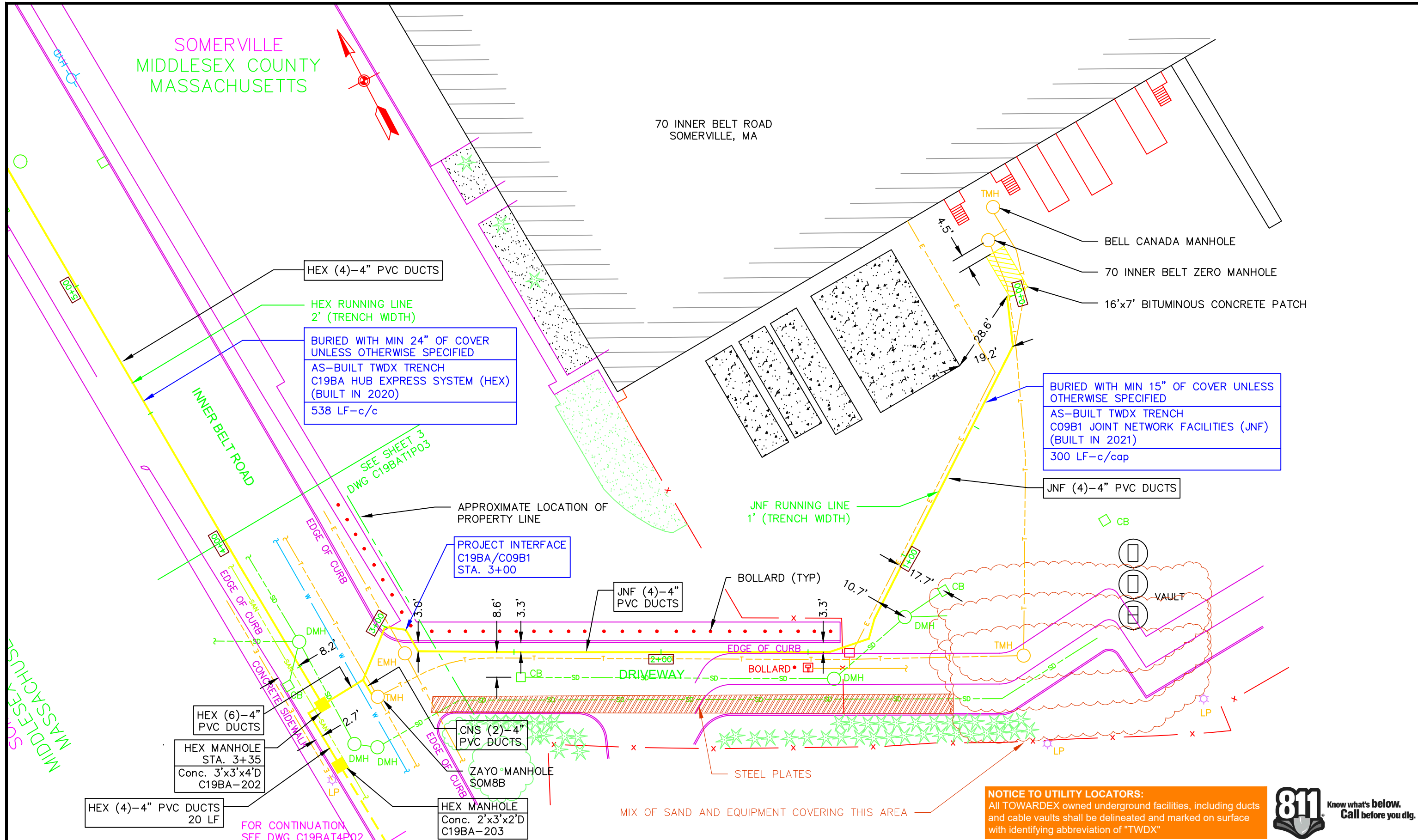

HEX (4)-4" PVC DUCTS

HEX RUNNING LINE
2' (TRENCH WIDTH)

BURIED WITH MIN 24" OF COVER
UNLESS OTHERWISE SPECIFIED
AS-BUILT TWDX TRENCH
C19BA HUB EXPRESS SYSTEM (HEX)
(BUILT IN 2020)
538 LF-c/c

BELL CANADA MANHOLE

70 INNER BELT ZERO MANHOLE

16'x7' BITUMINOUS CONCRETE PATCH

BURIED WITH MIN 15" OF COVER UNLESS
OTHERWISE SPECIFIED
AS-BUILT TWDX TRENCH
C09B1 JOINT NETWORK FACILITIES (JNF)
(BUILT IN 2021)
300 LF-c/cap

JNF (4)-4" PVC DUCTS

JNF RUNNING LINE
1' (TRENCH WIDTH)

PROJECT INTERFACE
C19BA/C09B1
STA. 3+00

JNF (4)-4" PVC DUCTS

BOLLARD (TYP)

EDGE OF CURB

DRIVEWAY

BOLLARD

EDGE OF CURB

CNS (2)-4" PVC DUCTS

ZAYO MANHOLE
SOM8B

HEX MANHOLE
Conc. 2'x3'x2'D
C19BA-203

HEX (6)-4" PVC DUCTS

HEX MANHOLE
STA. 3+35
Conc. 3'x3'x4'D
C19BA-202

HEX (4)-4" PVC DUCTS
20 LF

FOR CONTINUATION
SEE DWG C19BAT4PQ2

NOTICE TO UTILITY LOCATORS:
All TOWARDEX owned underground facilities, including ducts and cable vaults shall be delineated and marked on surface with identifying abbreviation of "TWDX"



Y:\IP Planning\HubExpress (HEX) Program\As Built System Diagrams\C19BATIP99.dwg
Feb 09,2021 - 10:14pm by gkeyes

Designed by J. CONNOR	Checked by J. KENNEDY	Date 2/3/2021	CONDUIT RECORD PLAN
Scale:			

PREPARED BY:

50 Mall Road, Suite 203, Burlington, MA 01803
p 781.221.8400 f 781.221.7117

PREPARED FOR:

TOWARDEX
Your network success story.

PROJECT TITLE:
**AS-BUILT CONDUIT PLACEMENT PLAN
70 INNER BELT ROAD
SOMERVILLE, MA 02143**

SHEET NUMBER:
2
OF 4 SHEETS